

Place  
First-Class  
Postage  
Here

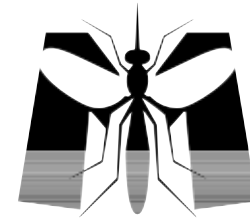

# MOSQUITO MAGNET<sup>®</sup> *Defender*

American Biophysics Corporation  
2240 South County Trail  
East Greenwich, RI 02818-1536

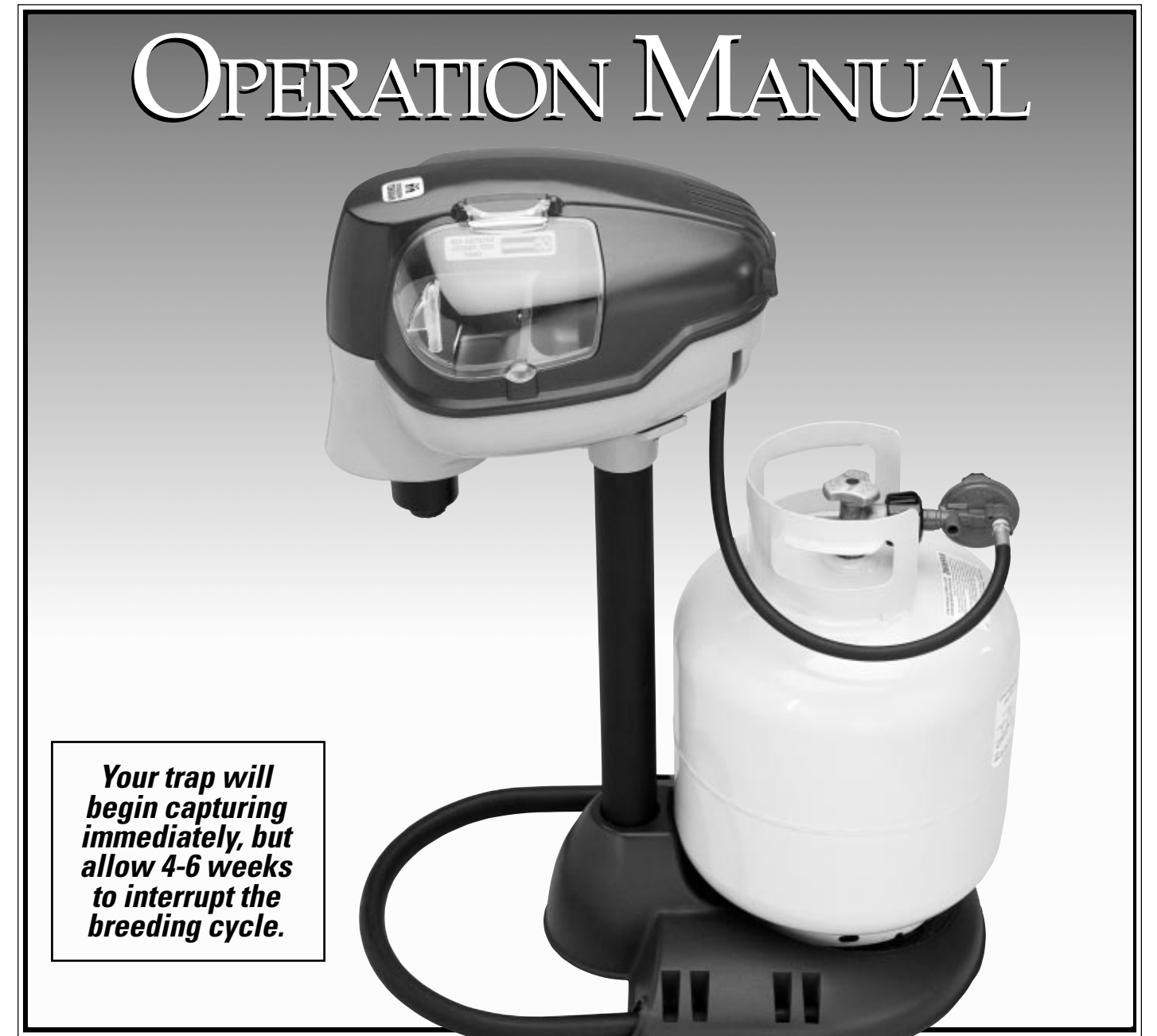

***Your trap will begin capturing immediately, but allow 4-6 weeks to interrupt the breeding cycle.***

*For Outdoor Use Only*



MADE IN USA

US Patents: No. 6,145,243, No. 6,286,249  
AU Patent No. 726575, NZ Patent No. 335035

**NOTICE: PLEASE READ THE ENTIRE MANUAL BEFORE ASSEMBLING AND STARTING UP YOUR MOSQUITO MAGNET DEFENDER.**

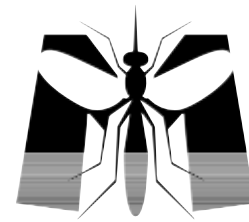

# MOSQUITO MAGNET Defender

## TABLE OF CONTENTS

1.	Safety.....	2-4
2.	Parts included.....	5
4.	Additional Components .....	6
5.	Assembly instructions.....	7-9
6.	Trap Placement.....	10
7.	Start-Up Instructions.....	10
8.	Shut-Down Instructions.....	11
9.	Tank Changing Tips.....	11
9.	Maintenance.....	11
10.	For Best Results.....	12
11.	Gas Reset Tool.....	12
12.	Quick-Clear Valve.....	13
13.	Burying The Cord.....	13
14.	Troubleshooting.....	14
15.	Warranty.....	15

## HOW THE MOSQUITO MAGNET WORKS

Humans exhale carbon dioxide (CO<sub>2</sub>), which has been scientifically proven to be the natural compound that mosquitoes and other biting insects use to navigate to people. The Mosquito Magnet mimics a person's breath by catalytically converting propane to carbon dioxide (CO<sub>2</sub>). The Mosquito Magnet can be placed near the mosquito's resting and breeding spots, trapping the mosquitoes at their source (see trap placement section). The female, egg-laying, biting mosquitoes are drawn away from you and to the Mosquito Magnet, where they are vacuumed into a net and dehydrate. Within 4-6 weeks, the reproductive cycles of your biting insect population are interrupted. **NO EGGS. NO INSECTS.** The Mosquito Magnet targets only biting insects, not beneficial insects such as butterflies, bees and moths.



**Congratulations on your Mosquito Magnet purchase!**  
Please read your owner's manual completely before assembling and operating your unit.

## SAFETY INSTRUCTIONS

### FOR YOUR SAFETY

If you smell gas:

1. Shut off gas to the appliance.
2. Extinguish any open flame.
3. If odor continues, immediately call your gas supplier.

### FOR YOUR SAFETY

Do not store or use gasoline or other flammable vapors and liquids in the vicinity of this or any other appliance.

**WARNING: For Outdoor Use Only**

Model No.:	DEFENDER
Serial No.:	
Type of Gas:	Propane
Manifold Pressure:	100-110 psi
Minimum Gas Supply Pressure:	11.0 in. WC
Input Rating:	650Btu/Hr.
Minimum Clearances:	20-24"

**For Outdoor Use Only. If Stored Indoors, Detach and Leave Propane Cylinder Outdoors.**

■ **WARNING:** Improper installation, adjustment, alteration, service or maintenance can cause injury or property damage. Read the installation, operating and maintenance instructions thoroughly before installing or servicing this equipment.

- **CAUTION:** The gas pressure regulator provided with this appliance must be used. This regulator is set for an outlet pressure of 11.0 in. Water Column.
- The gas supply must be turned off at the LP-Gas supply cylinder when this appliance is not in use.
- The installation must conform with local codes or, in the absence of local codes, with the National Fuel Gas Code, ANSI Z223.1-1998 for US and with the CAN1-B149 for Canada.
- Adequate clearances of 20-24 inches around air openings into the combustion chamber, clearances from combustible material, provisions for accessibility and for combustion and ventilating air supply.
- The minimum inlet gas supply pressure is 11"WC from regulator.
- To test for a gas leak, place soapy water around the regulator. If bubbles appear, there is a gas leak.
- Route the power cord in the safest possible manner to avoid personal injury.
- The hose assembly must be replaced prior to the appliance being put into operation if there is evidence of excessive abrasion or wear, or if the hose is damaged. The instructions shall state that the replacement hose assembly shall be that specified by the manufacturer.
- The Mosquito Magnet is equipped with a hot surface ignition device. Failure to follow starting procedure will result in the trap not starting.

*Children and adults should be alerted to the hazards of high surface temperatures and should stay away to avoid burns or clothing ignition.*

*Young children should be carefully supervised when they are in the area of the heater. Keep out of reach of children.*

*Clothing or other flammable materials should not be hung from the heater, or placed on or near the heater.*

- Installation and repair should be done by a qualified service person. The heater should be inspected before use and at least annually by a qualified service person. More frequent cleaning may be required as necessary. It is imperative that the control compartment, burners, and circulating air passageways of the heater be kept clean.
- Keeping the Mosquito Magnet area clear and free from combustible materials, gasoline, and other flammable vapors and liquids. The appliance is not to be used in locations where flammable vapor or explosive dust is likely to exist.
- Do not obstruct the flow of combustion and ventilation air.
- Keeping the ventilation openings of the cylinder enclosure free and clear from debris.
- Clean the Mosquito Magnet with a water damp cloth, if necessary.
- A maximum of a 20 lb. LP-Gas cylinder shall be used.

- The LP-Gas cylinder must be provided with a shutoff valve terminating in an LP-Gas supply cylinder valve outlet specified for Connection No. 510 in the Standard for Compressed Gas Cylinder Valve Outlet and Inlet Connections, ANSI/CGA-V-1-1977.
- The LP-Gas cylinder supply system must be arranged for vapor withdrawal and the cylinder must include a collar to protect the cylinder valve.
- The LP-Gas cylinder used shall be constructed and marked in accordance with the specifications for LP-Gas cylinders of the U.S. Department of Transportation (DOT).
- The Mosquito Magnet shall be used outdoors only in a well ventilated space and shall not be used in a building, garage, or any other enclosed area.
- The LP-Gas cylinder must be disconnected and removed from the appliance, if the appliance is stored indoors.
- LP-Gas cylinders must be stored outdoors in a well ventilated area out of the reach of children. Disconnected cylinders must have threaded valve plugs tightly installed and must not be stored in a building, garage, or any other enclosed area.
- The pressure regulator and hose assembly supplied with this appliance must be used for connection to the LP-Gas cylinder. Replacement pressure regulators and hose assemblies must be specified by the manufacturer.
- Avoid improper use of extension cords. Keep connections away from moisture and avoid damage to the cord.
- If the supply cord is damaged, it must be replaced by the manufacturer or its service agent or a similarly qualified person in order to avoid hazard.
- **WARNING-** an electric shock hazard may exist if water from a garden hose is directed at the Mosquito Magnet.

Please contact American Biophysics Corporation if you experience any problems with your Mosquito Magnet:  
**1-877-699-8727**



American Biophysics Corporation  
2240 South County Trail  
East Greenwich, RI 02818-1536  
P: 401-884-3500 F: 401-884-6688  
www.mosquitomagnet.com  
email: info@mosquitomagnet.com



## PARTS INCLUDED

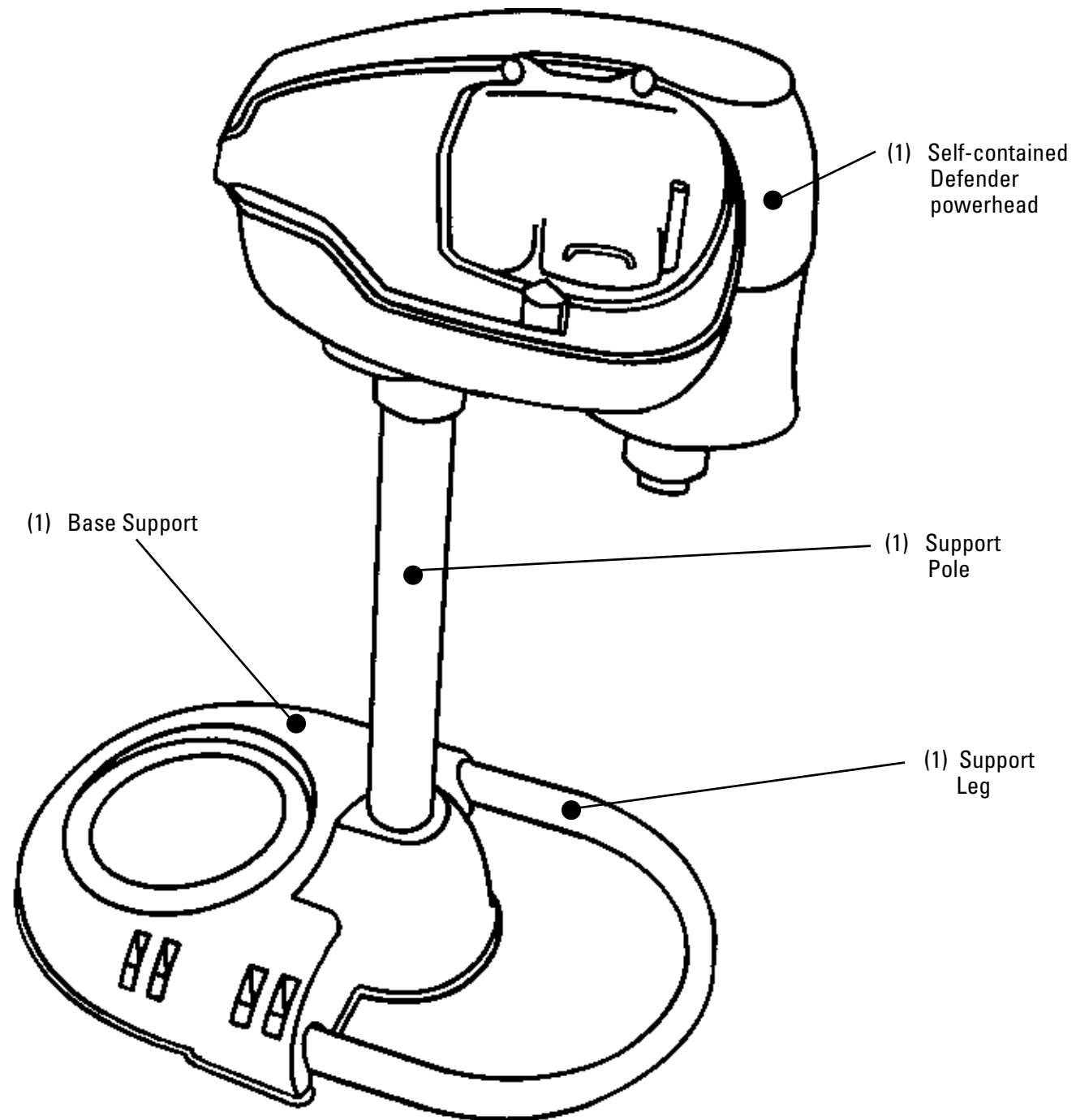

5

## ADDITIONAL COMPONENTS

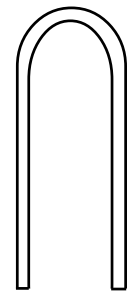
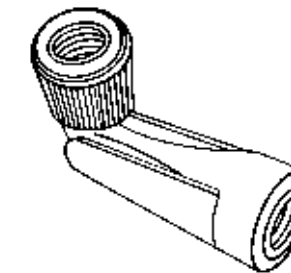
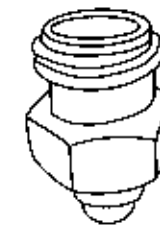
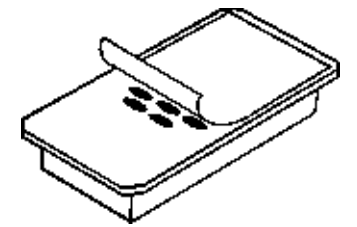
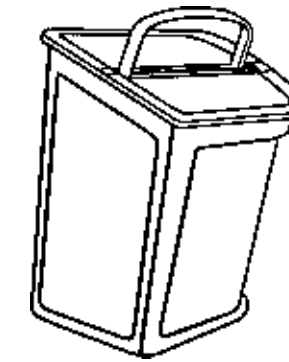
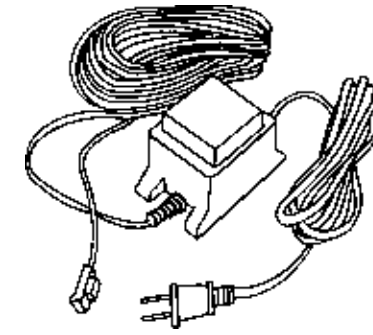

### IMPORTANT NOTICE

Per Federal Regulations, a CO<sub>2</sub> Cartridge has not been included with your purchase. Please visit [www.mosquitomagnet.com](http://www.mosquitomagnet.com) to purchase or visit your local Mosquito Magnet dealer.

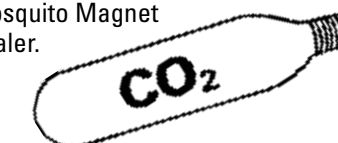

6

## ASSEMBLY INSTRUCTIONS

### IMPORTANT NOTES:

1. Your trap will begin capturing immediately, but allow 4-6 weeks to interrupt the breeding cycle.
2. DO NOT MOVE MOSQUITO MAGNET WITH TANK ATTACHED. DISCONNECT TANK FROM REGULATOR BEFORE RELOCATING TRAP TO AVOID DAMAGE TO REGULATOR OR TRAP.
3. Should you experience an interruption of power, be sure to restart trap.
4. Trap can be left running in the rain.

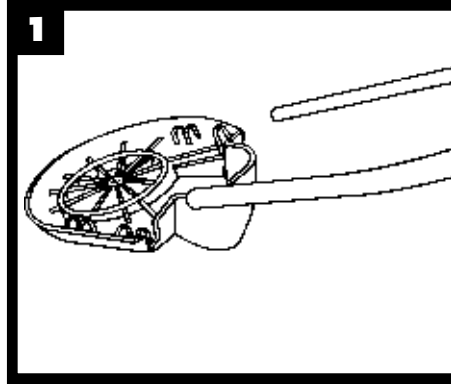

1 Place base upside down on a flat surface, slide U-shaped support legs into slots on base until they lock in place.

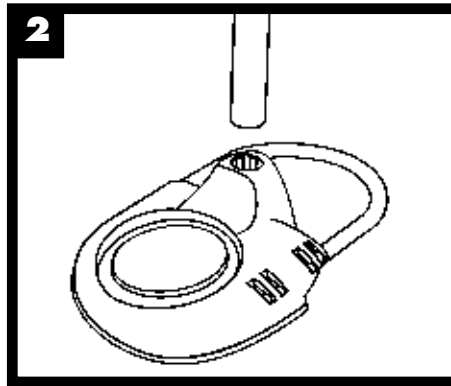

2 Turn base and leg assembly right-side-up and place support pole into cavity on base.

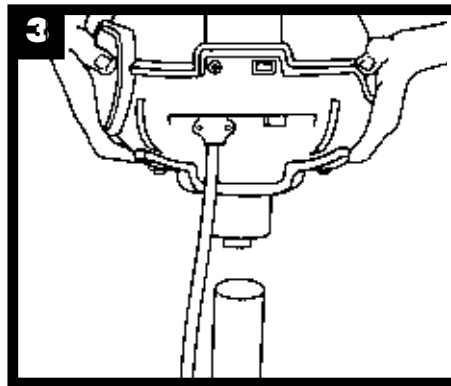

3 Place Defender power head onto pole. Press down firmly with two hands to secure.

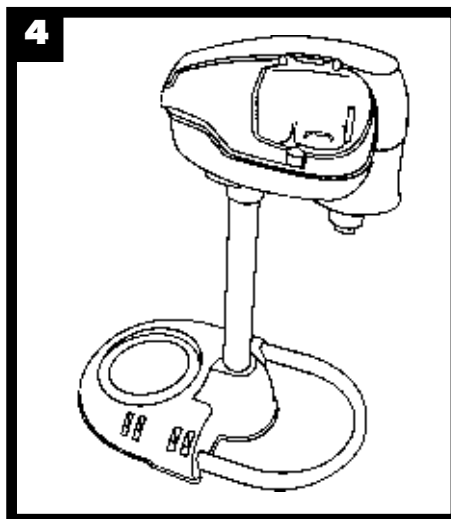

4 Completed assembly should have the front of power head in the same direction as base U-shaped legs.

7

## ASSEMBLY INSTRUCTIONS

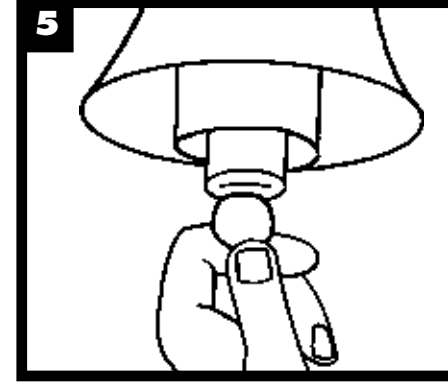

5 Peel cover from attractant cartridge. Using a coin, unscrew cover from attractant compartment inside of CO<sub>2</sub> tube.

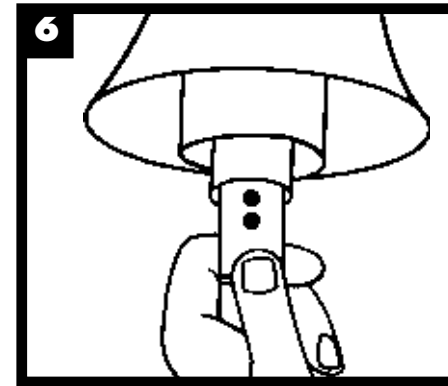

6 Slide attractant cartridge into compartment. Recap and secure tightly.

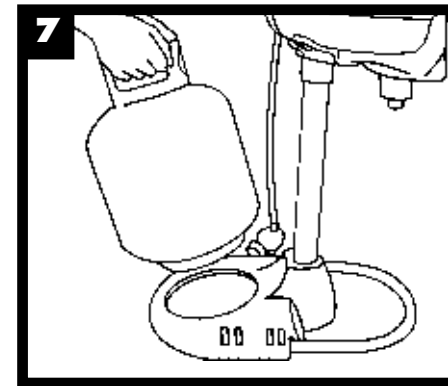

7 Place propane tank onto base into the molded cradle supplied.

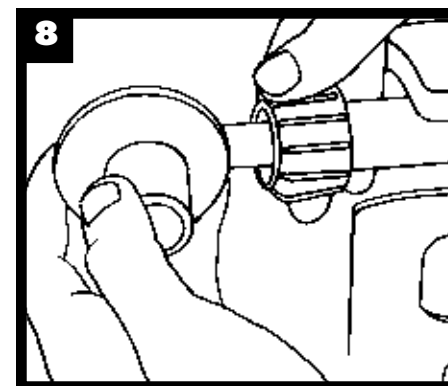

8 Making sure propane tank is fully closed, attach propane regulator hose to propane tank. Secure tightly by hand. Do not use tools.

8

## ASSEMBLY/STARTING INSTRUCTIONS

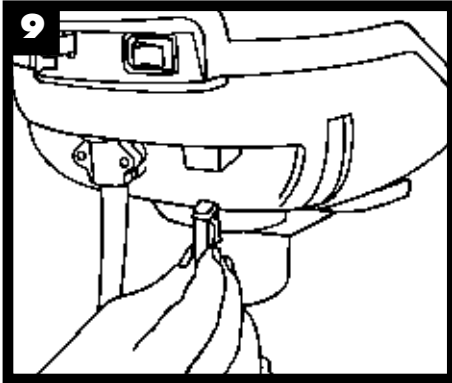

9 Plug power connector into the Defender unit power slot located on the back of the power head.

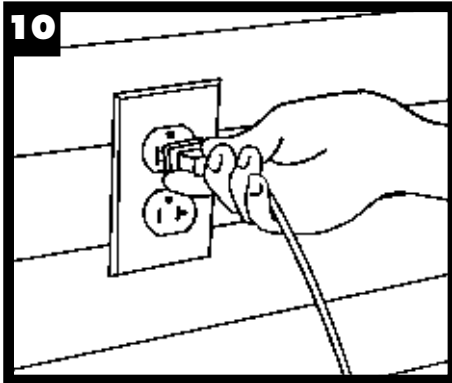

10 Plug adaptor into properly grounded electrical outlet. This adaptor is not intended to be mounted. For UL Listed trap use 120 Vac adaptor. For CE marked trap use 230 Vac adaptor.

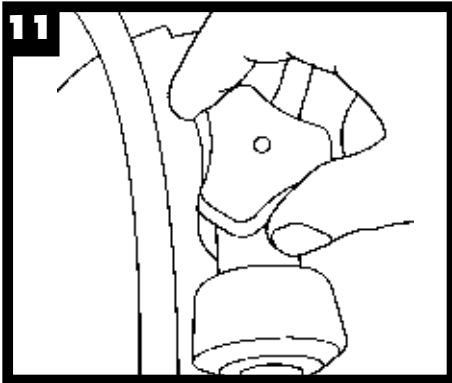

11 Turn propane on by slowly turning counterclockwise. Take care *not* to turn too quickly to avoid engagement of safety check valve in regulator.

**CONTINUE  
TO STARTING  
INSTRUCTIONS.**

## TRAP PLACEMENT

- 1 Determine the direction of the prevailing wind.
- 2 Stand in the center of the area you are trying to protect and look toward the prevailing wind. Proper placement of the Mosquito Magnet will be 30-40 feet in front of you, within 5-6 feet of ground cover (i.e., bushes, flowerbeds, treeline, marshbed, etc.)
- 3 It is recommended that the trap be placed in the shade.
- 4 Do not place trap directly above water source (sprinklers, hose, etc.).
- 5 Make sure unit is not directly up against a blockade such as a building or fence.
- 6 Trap must be placed on level ground to avoid tipping or uneven propane distribution.
- 7 For more information, refer to trap placement section of our website at [www.mosquitomagnet.com](http://www.mosquitomagnet.com).

## STARTING INSTRUCTIONS

It is recommended that you read the entire manual before starting the Mosquito Magnet Defender

- 1 Connect regulator to propane tank.
- 2 Plug power connector into the trap.
- 3 Plug AC adapter into electrical socket. To avoid the risk of electrical shock, connect only to properly grounded outlets. Adaptor unit is not intended to be mounted.
- 4 *Slowly* turn propane tank on (turn valve counter clockwise).
- 5 Turn rocker switch to "on" position.
- 6 The red light on the switch will flash for up to 20 minutes (warm up phase).
- 7 Once the light stops flashing and is solid the Mosquito Magnet is fully operational.

## SHUT DOWN INSTRUCTIONS

To shut down the Defender simply close the valve on the propane tank and switch to "Off" position.

**DO NOT UNPLUG UNIT. MOSQUITO MAGNET DEFENDER MUST REMAIN PLUGGED IN FOR 5 MINUTES AFTER SHUT DOWN OR UNTIL FAN STOPS TO AVOID HEAT DAMAGE.**

Any open octenol or other added attractant packages should be removed and discarded. The net should also be discarded prior to storing the Mosquito Magnet Defender.

**STORAGE:** Mosquito Magnet Defender should be stored indoors in the off-season. Cover unit with trap cover (available at [www.mosquitomagnet.com](http://www.mosquitomagnet.com)) or with a tarp and secure tightly at the bottom to keep out dust, spider webs and other debris.

**NOTE:** It is recommended that you use the Quick-Clear valve before seasonal storage to avoid build-up of contaminants during off-season.

## TANK CHANGING TIPS

When attaching the regulator handle to a tank after a tank change, be sure to fully tighten the regulator handle onto the tank. No need to use tools, but do turn the handle as far as possible by hand. When this is done, loosen the handle 1/4 turn, then re-tighten the handle. Frequently this action will result in additional turns beyond the 1/4 turn. The purpose for this is to fully engage the regulator onto the tank. If the regulator is not fully engaged, the flow of gas may be restricted to the point where the trap will show a gas empty code. If this occurs, press the off button, close the tank valve, and remove the regulator from the tank. Re-attach the regulator and try again.

## MAINTENANCE

- 1 Propane tank should be refilled every 21 days.
- 2 Empty or replace net every 21 days.
- 3 See added attractant packaging for maintenance/ replacement instructions.
- 4 Accessories can be ordered at [www.mosquitomagnet.com](http://www.mosquitomagnet.com)
- 5 Store Octenol in a cool, dry place.
- 6 Clean net periodically for tree pollen or debris.
- 7 In the event the side screen becomes clogged, remove and clean gently with toothbrush and cold water.
- 8 Periodically wipe down the outside of the Mosquito Magnet with a clean water damp cloth.

## FOR BEST RESULTS

- 1 Your trap will begin capturing immediately, but allow 4-6 weeks to interrupt the breeding cycles.
- 2 Should you experience an interruption of power, be sure to restart the trap.
- 3 Clear door must be closed tightly to maximize catch.
- 4 Never spray insecticide in or around trap.
- 5 **DO NOT MOVE TRAP WITH TANK ATTACHED! TANK MUST BE DISCONNECTED FROM REGULATOR BEFORE TRAP IS RELOCATED TO AVOID DAMAGE TO REGULATOR AND/OR TRAP. BE ADVISED, DAMAGE CAUSED FROM FAILURE TO COMPLY WITH THIS INSTRUCTION IS NOT COVERED UNDER WARRANTY.**
- 6 Trap can be left running in the rain.
- 7 If using lime or lawn regenerative compounds, be sure to shut down the Mosquito Magnet first to prevent dust or fine mist from being drawn into trap and clogging net.
- 8 A standard, outdoor rated extension cord may be used to increase your trap area.
- 9 Octenol cartridge does not disintegrate. Smell will dissipate over time.



## GAS RESET TOOL INSTRUCTIONS

If your Mosquito Magnet fails to start, it may be the result of poor gas flow from the propane tank through the regulator to the trap. The attached tool has been designed to reset the internal mechanisms of the propane regulator and release any back pressure from your tank. Please follow these steps:

- 1 Shut down your Mosquito Magnet.
- 2 Completely close the propane tank valve by turning to the "Off" position. (turn valve clockwise)
- 3 Disconnect the regulator from the propane tank valve.
- 4 Screw the threaded end of the reset tool into the propane tank valve until it is fully engaged. You may hear a small "hiss" sound. This is the pressure being released from the propane tank. Note: the threads in the tank valve are left handed threads. (turn valve counter clockwise)
- 5 Screw the regulator connector to the opposite end of the reset tool until fully engaged. Note: hold the reset tool to prevent it from backing out of the tank.
- 6 The regulator and propane tank are now reset. Disconnect the reset tool from the regulator connector and the propane tank.
- 7 Re-attach regulator connector to the propane tank valve.
- 8 Slowly turn the propane tank valve on .
- 9 Restart your trap.

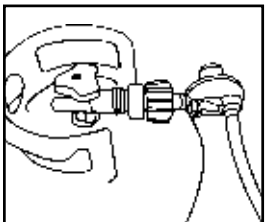
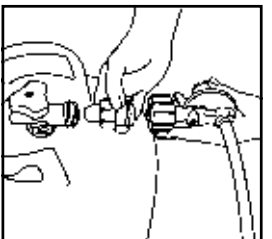

Technical Support: 1-877-699-8727  
Gas Reset Tool  
Extinguish all smoking materials prior  
to use of Gas Reset Tool.

## QUICK-CLEAR VALVE

Recommended for use at first tank change, and every second tank change thereafter. Also recommended for use before seasonal storage to avoid build up of contaminant's during off-season.

The Quick-Clear valve is used to clear out propane contaminants in the fuel line, which may block the flow of propane from the tank to your Mosquito Magnet. The Quick-Clear valve is a gold, threaded knob located on the back of your trap. It should be used with the black and gold, L-shaped adapter included in the box with your Mosquito Magnet, and a 12 gram threaded CO<sub>2</sub> cylinder available on our website at [www.mosquitomagnet.com](http://www.mosquitomagnet.com) or your local Mosquito Magnet Dealer.

Important: Extinguish all smoking materials prior to use of Quick-Clear Valve.  
Do not stand directly behind cylinder during operation.

- 1** Shut down your Mosquito Magnet. Let fan run until it stops. (about 5 mins.)
- 2** Close the propane tank valve by turning to the "Off" position. (turn the tank valve clockwise)
- 3** Remove the protective cap from Quick-Clear valve on your trap.
- 4** Hand-screw gold end of L-shaped adapter on to Quick-Clear valve, until tight.
- 5** Hand-screw the CO<sub>2</sub> cylinder into black end of L-shaped adapter clockwise until hand tight.
- 6** Unscrew CO<sub>2</sub> cylinder 1/4 turn only in counter-clockwise direction. The flow of CO<sub>2</sub> will begin, lasting approximately 3 minutes. Be sure to allow CO<sub>2</sub> to run out completely. (hissing will stop when cylinder is empty. Note: CO<sub>2</sub> cylinder will be cold to the touch)
- 7** Continue unscrewing the CO<sub>2</sub> cylinder to remove. Discard empty CO<sub>2</sub> cylinder after use, it is not reusable or re-fillable. (Use caution when removing CO<sub>2</sub> cylinder, as some residual CO<sub>2</sub> may come out at this time.)
- 8** Remove L-shaped adapter by unscrewing gold end clockwise. (Remember to KEEP the black and gold adapter for future use!)
- 9** Replace Quick-Clear valve protective cap, and proceed with normal start up of your Mosquito Magnet.

If use of Quick-Clear valve feature does not resolve starting trouble, contact Tech Support 877-699-8727.

Remember to KEEP the black and gold adapter for future use

### Use of protective eyewear is recommended

Important: Extinguish all smoking materials prior to use of Quick-Clear valve.

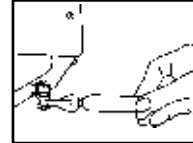
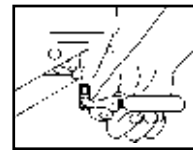
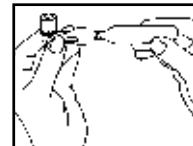
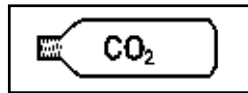
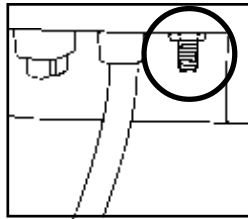

## BURYING THE POWER CORD

Use the Cord Burying Clips supplied. Place clips approximately 5' apart, tap into ground with a hammer making sure not to damage power cord. Make sure unit is unplugged and in proper position. For alternate placement follow steps illustrated below.



Use straight-edge shovel or garden spade and dig a trench about 3-4 inches deep from power source to trap.



Place cord into trench carefully stretching as you go to remove any twists in cord.



Use cedar shingle or folded cardboard to place cord into bottom of trench. Recover the trench with removed soil.

13

## TROUBLESHOOTING GUIDE

PROBLEM	POSSIBLE CAUSES	SOLUTIONS
<b>Unit won't start</b>	<ol style="list-style-type: none"> <li>1) Is Propane tank empty?</li> <li>2) If Propane tank is new, has it been purged?</li> <li>3) There could be a loose connection.</li> <li>4) If tank has been opened too quickly, security check valve may have triggered.</li> </ol>	<ol style="list-style-type: none"> <li>1) Weigh tank and check against "empty" weight written on tank.</li> <li>2) Bring tank to filling location. Air may be in fuel line. Ask for tank to be purged. *Hint-If you have another propane powered device operating on a standard, 20lb propane tank, try hooking that tank up to the Mosquito Magnet to verify that your issue is with your tank.</li> <li>3) Verify all electrical connections. Make sure regulator is fully engaged, and propane tank valve is fully open.</li> <li>4) Refer to Reset Tool Instructions on page 12.</li> </ol>
<b>Unit won't stay running</b>	<ol style="list-style-type: none"> <li>1) Issues 1 and 3 may apply.</li> <li>2) Fuel line may be blocked by propane contaminates.</li> <li>3) Regulator is not fully engaged.</li> </ol>	<ol style="list-style-type: none"> <li>1) Go through above steps 1 &amp; 3.</li> <li>2) See Quick-Clear valve instructions.</li> <li>3) See Tank Changing Tips on page 11.</li> </ol>
<b>Low or No Catch</b>	<p><b>If not getting bitten</b></p> <ol style="list-style-type: none"> <li>1) Insects may not be out yet.</li> <li>3) Biting insect reproductive cycles have not yet been broken.</li> <li>4) CounterFlow may be disrupted.</li> <li>5) Added attractant may be incompatible with species of mosquito.</li> </ol> <p><b>If getting bitten</b></p> <ol style="list-style-type: none"> <li>2) Trap placement issue.</li> </ol>	<ol style="list-style-type: none"> <li>1) Verify temperature is consistently above 50°F (10°C).</li> <li>2) Follow steps in the "Trap Placement" section of your owner's manual or go to <a href="http://www.mosquitomagnet.com">www.mosquitomagnet.com</a> "Placement" section.</li> <li>3) Keep trap in constant operation 24 hours/day, 7 days/week for 4-6 weeks to interrupt the breeding cycle.</li> <li>4) Conduct a "tissue test" by holding a facial tissue up to horn to check for airflow.</li> <li>5) Call your local mosquito control department to find out if Asian Tiger is your primary species of mosquito. <i>Asian Tiger mosquitoes are not attracted to Octenol.</i> Remove Octenol cartridge from your unit, and wipe Octenol compartment with alcohol wipe to eliminate scent.</li> </ol>



All of us at American Biophysics want you to get complete satisfaction from your Defender. Should you have any problems you cannot resolve, simply call one of our trained Technical Service Representatives at:

**1-877-699-8727. We will help you get up and running.**

14



# LIMITED WARRANTY

This warranty, (1) year from the purchase of the unit, is extended only to the original purchaser/user of products.

American Biophysics Corp. warrants its products to be free from defects in materials and workmanship for the warranty period by the original purchaser/user.

For warranty service, please contact American Biophysics Technical Center (877-699-8727). Please indicate the nature of the defect.

After calling for warranty service, please contact the retailer where you bought your unit to determine if it is covered by any exchange policy.

If American Biophysics Corp. determines there may be a defect, American Biophysics Corp. will issue a return authorization (RMA) number.

The defective unit or parts must be returned for warranty inspection using the RMA number, when applicable, as identification within (30) days of return authorization date. DO NOT return products to our factory without our prior consent, as they, as well as C.O.D. shipments will be refused. American Biophysics Corp., at its option, shall replace the unit, replace the defective part(s) and return such unit to you. American Biophysics Corp.'s sole obligation and your exclusive remedy under this warranty shall be limited to such replacement.

**LIMITATIONS AND EXCLUSIONS:** The warranty shall not apply to problems arising from normal wear, or failure to adhere to the enclosed instructions. In addition, the foregoing warranty shall not apply to serial numbered products if the serial number has been removed or defaced; products subject to negligence, accident, improper operation, maintenance or storage; products damaged by circumstances beyond American Biophysics Corp.'s control; or products modified (including, but not limited to modifications through the use of unauthorized parts or attachments) or repaired by anyone other than American Biophysics Corp. or its designee.

THE FOREGOING WARRANTY IS EXCLUSIVE AND IN LIEU OF ALL OTHER WARRANTIES, EXPRESS OR IMPLIED, INCLUDING WITHOUT LIMITATION THE IMPLIED WARRANTIES OF MERCHANTABILITY AND FITNESS FOR A PARTICULAR PURPOSE. IT SHALL NOT EXTEND BEYOND THE DURATION OF THE EXPRESS WARRANTY PROVIDED HEREIN, AND THE REMEDY FOR VIOLATIONS OF ANY WARRANTY SHALL BE LIMITED TO REPAIR OR REPLACEMENT OF THE DEFECTIVE PRODUCT PURSUANT TO THE TERMS CONTAINED HEREIN. AMERICAN BIOPHYSICS CORP. SHALL NOT BE LIABLE FOR ANY CONSEQUENTIAL OR INCIDENTAL DAMAGES WHATSOEVER.

This warranty gives you specific legal rights and you may also have other legal rights which may vary based on location.

DETACH HERE BEFORE MAILING

DETACH HERE BEFORE MAILING

# PRODUCT REGISTRATION

Mail completed form today or register on-line at [www.mosquitomagnet.com](http://www.mosquitomagnet.com)

First Name \_\_\_\_\_  
Last Name \_\_\_\_\_  
Address \_\_\_\_\_  
City \_\_\_\_\_  
State/Province \_\_\_\_\_ Zip Code \_\_\_\_\_  
Country \_\_\_\_\_  
Phone Number \_\_\_\_\_  
Email Address \_\_\_\_\_

**1. How did you find out about the Mosquito Magnet (check all that apply)?**

- Radio Ad     Direct Mail     TV Ad  
 Friend/Family     Website     Magazine Ad  
 Newspaper Ad     News Article (newspaper, magazine, TV, etc.)  
 Frontgate     In-Store Display     Other

**2. In your household who decided to purchase the Mosquito Magnet?**

- Male     Female     Both

**3. What is your marital status?**

- Married     Single

**4. Are there any children in your household?**

- Yes     No

**5. What are the two most important reasons influencing this purchase?**

- Protection from disease  
 Science/technology behind product  
 Recommendation of friend/family member  
 Recommendation of salesperson  
 Reputation of quality  
 Comfort  
 Received as gift  
 Other

**6. What is your age?**

- 25-35     36-45     46-55     56-70     70+

**7. What is your level of education?**

- High School Diploma     College Degree     Graduate Degree     Doctoral Degree     Technical/Professional

**8. Which best describes the size of your yard?**

- 1/4-1/2 acre     1/2-3/4 acre     3/4-1 acre     1-2 acres

**9. What is your annual income?**

- \$25,000-40,000     \$40,000-60,000     \$60,000-90,000     Over \$90,000

**10. What other brands of insect abatement have you tried?**

- Zappers     Sprays     Pesticides     Other CO<sub>2</sub> Traps Name \_\_\_\_\_

**11. Would you consider giving a testimonial once you are thoroughly convinced of the effectiveness of the Mosquito Magnet?**

- Yes     No

**12. Would you recommend the Mosquito Magnet to a friend?**

- Yes     No

**13. Were the assembly directions and operation instructions explained clearly and simply?**

- Yes     No

**14. Did you require customer service?**

- Yes     No

## NECESSARY INFORMATION

**IN ORDER TO PROPERLY REGISTER YOUR PRODUCT WITH AMERICAN BIOPHYSICS CORPORATION, THE FOLLOWING INFORMATION IS REQUIRED.**

Type of unit: \_\_\_\_\_  
Serial Number: \_\_\_\_\_  
Date of purchase: \_\_\_\_\_  
Place of purchase: \_\_\_\_\_

**Consumer Confidentiality**

All of the information that has been gathered on this reply card is solely for the internal sales and marketing efforts of American Biophysics Corporation. None of the information that you may have provided will be sold, rented or leased to any other company, organization or agency for any purpose whatsoever. None of this information will be posted on our company website or any other vehicle that can be obtained by the public domain.

If you wish to make additional comments or testimonials about our product, please address them separately and send them to our Marketing Department at the address listed inside the manual.