

### Features

- 18 gauge stainless steel
- Self-rimming
- Double (equal) compartment
- Includes installation hardware
- 2-hole (-2) or single-hole (-1)
- 42" (106.7 cm) x 22" (55.9 cm)

### SELF-RIMMING KITCHEN SINK K-3231

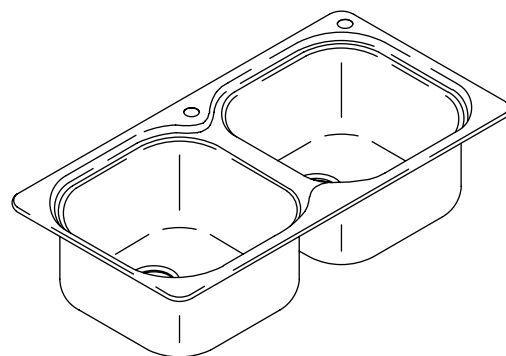

### Codes/Standards Applicable

Specified model meets or exceeds the following:

- ASME A112.19.3
- IAPMO/UPC

### Colors/Finishes

- NA: None applicable

#### Accessories:

- CP: Polished Chrome
- 0: White
- NA: None applicable
- Other: Refer to Price Book for additional colors/finishes

### Specified Model

Model	Description	Colors/Finishes
K-3231-2	2-hole sink	<input type="checkbox"/> NA
K-3231-1	Single-hole sink	<input type="checkbox"/> NA

Optional Accessories			
K-2989	Countertop cutting board	<input type="checkbox"/> NA	
K-3191	Bottom basin rack	<input type="checkbox"/> 0 White	<input type="checkbox"/> Other_____
K-3279	Wire rinse basket	<input type="checkbox"/> 0 White	<input type="checkbox"/> Other_____
K-8801	Duostrainer® sink strainer	<input type="checkbox"/> CP	<input type="checkbox"/> Other_____

### Product Specification

The self-rimming kitchen sink shall be 42" (106.7 cm) in length and 22" (55.9 cm) in width. Sink shall be made of 18 gauge stainless steel. Sink shall be double (equal) compartment. Sink shall be 2-hole (-2) or single-hole (-1) faucet punched. Sink shall include installation hardware. Sink shall be Kohler Model K-3231-\_\_\_\_\_.

## Technical Information

Fixture*:	
Basin area	18" (45.7 cm) x 18" (45.7 cm)
Water depth	9-1/4" (23.5 cm)
Drain holes	3-5/8" (9.2 cm) D.
Faucet holes	1-7/16" (3.7 cm) D.
*Approximate measurements for comparison only.	
Included components:	
Fastener pack	1023180

## Installation Notes

Install this product according to the installation guide.

Cutout is 41-1/2" (105.4 cm) x 21-1/2" (54.6 cm) with 1-1/2" (3.8 cm) radius corners.

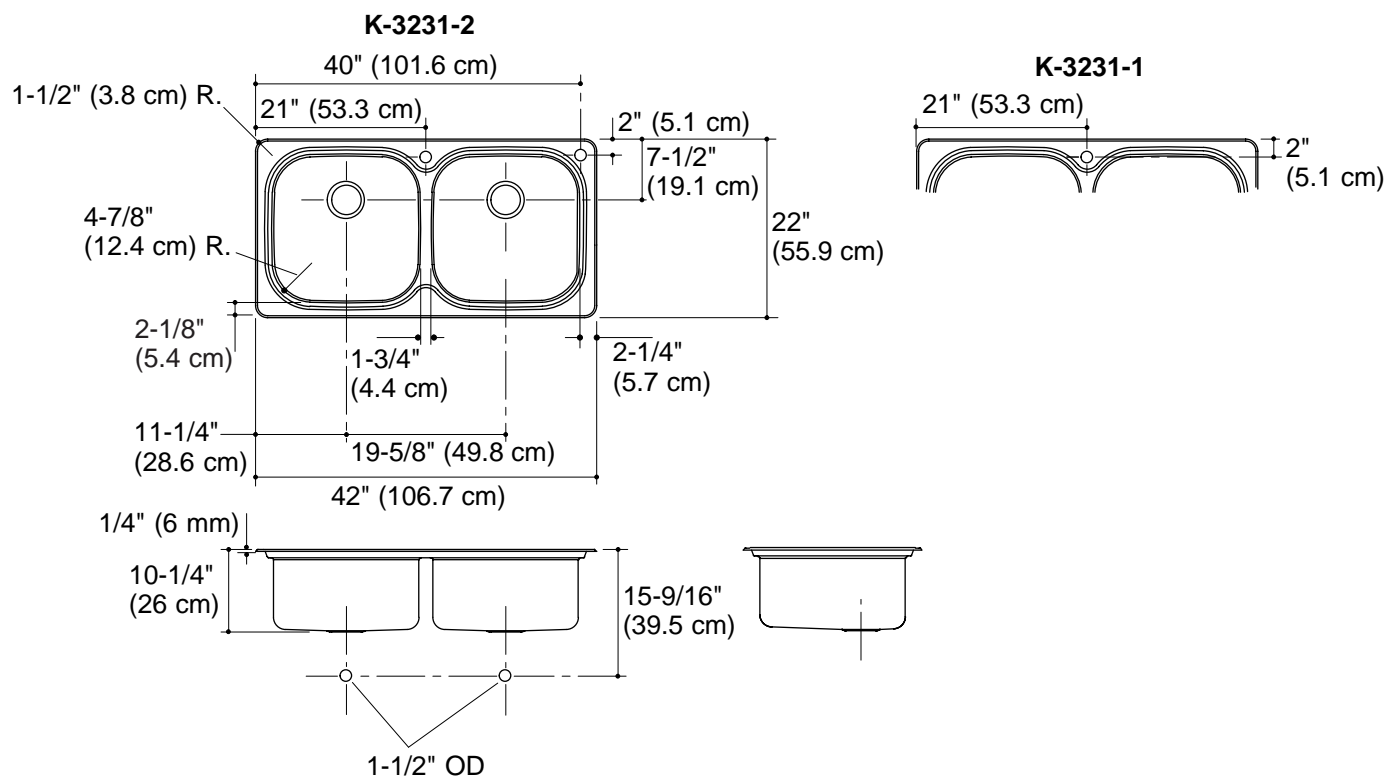

## Product Diagram